

RANDOLPH COUNTY
BASE AND PAVE MAP

040397
76138E.dwg, 76138E.dwg, SR 2014, and SR 1372, Randolph, overview map.dgn

MAP #1

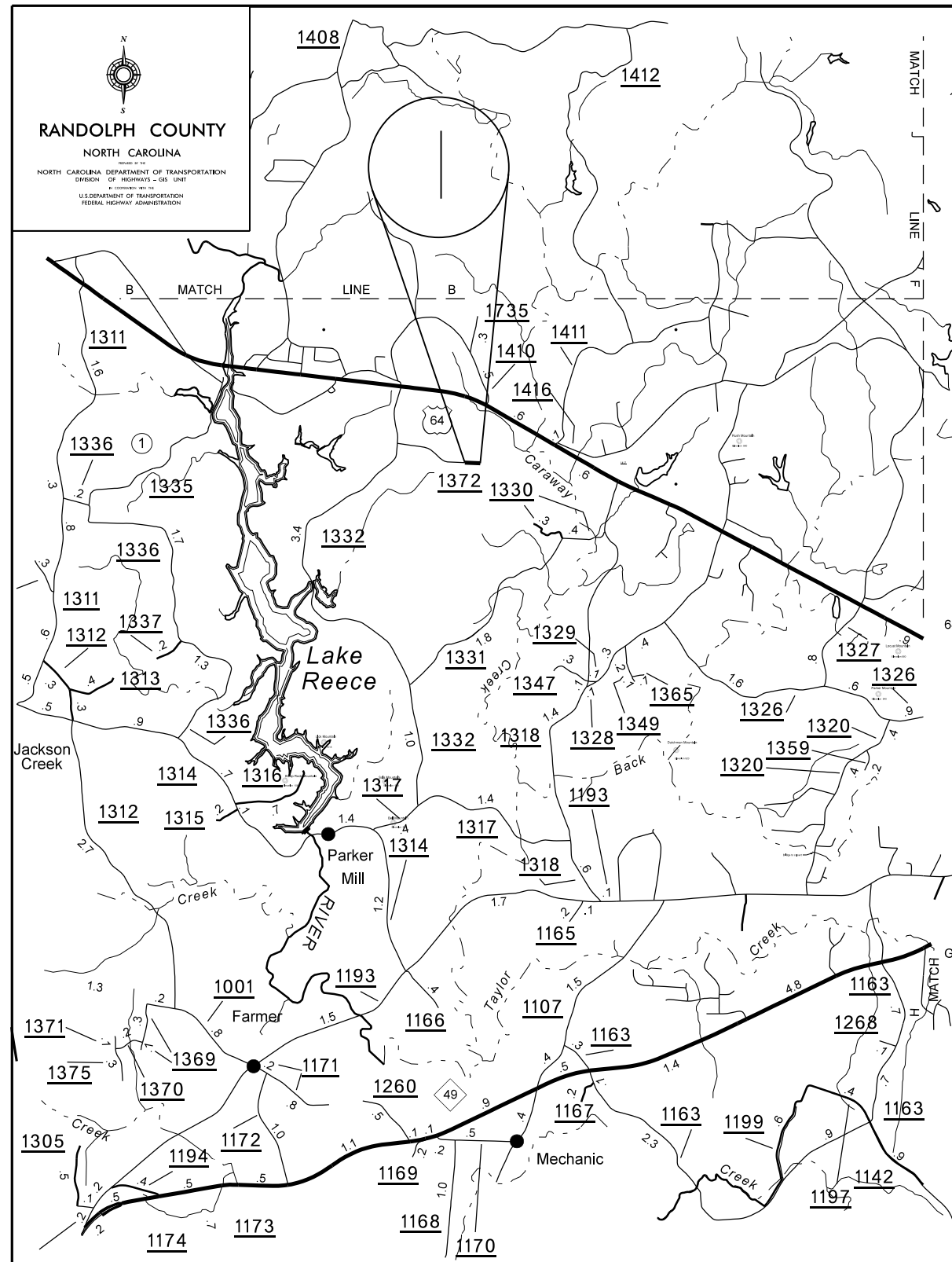

MAP #2

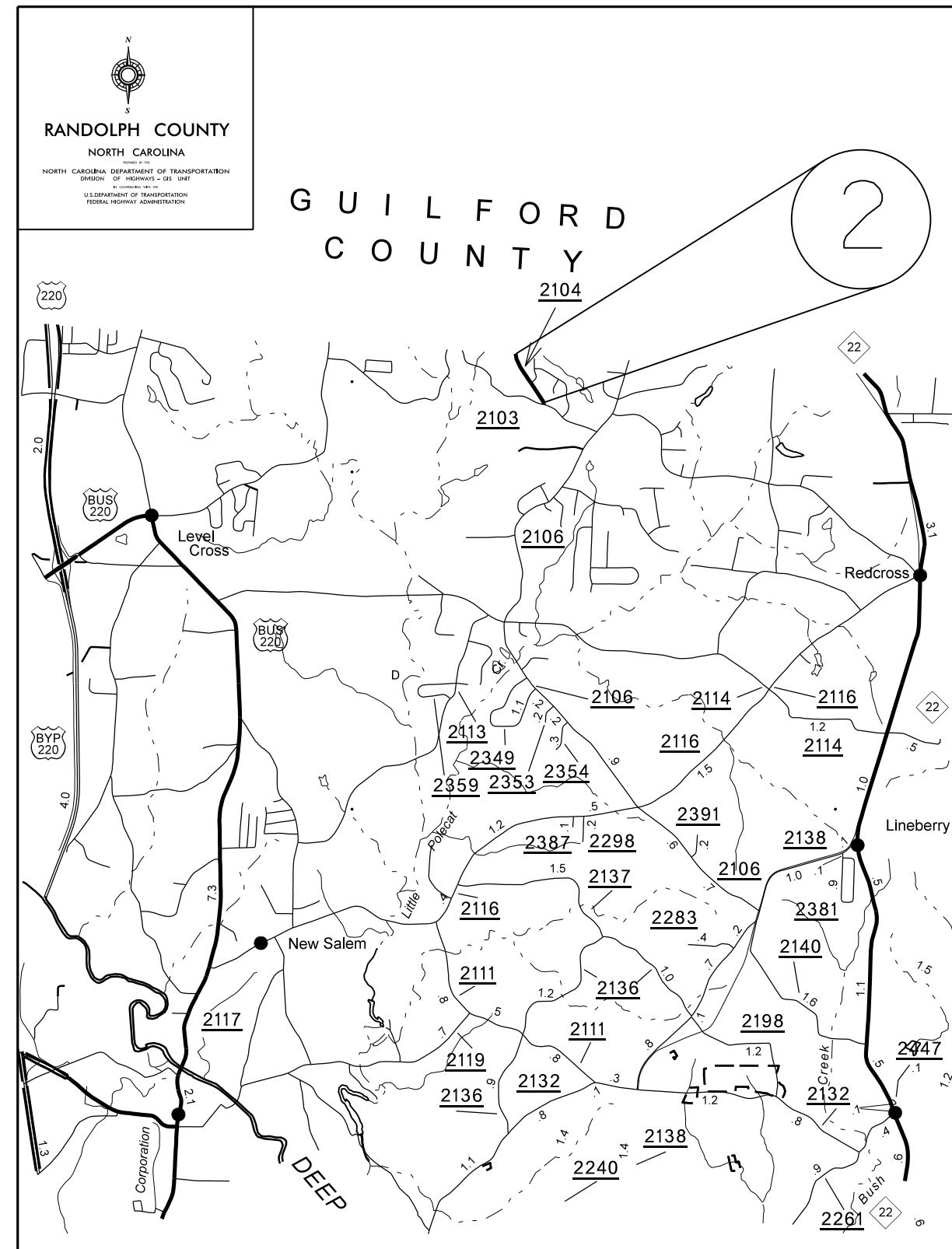

TYPICALS NOT TO SCALE

TYPICAL SECTION NO. 1

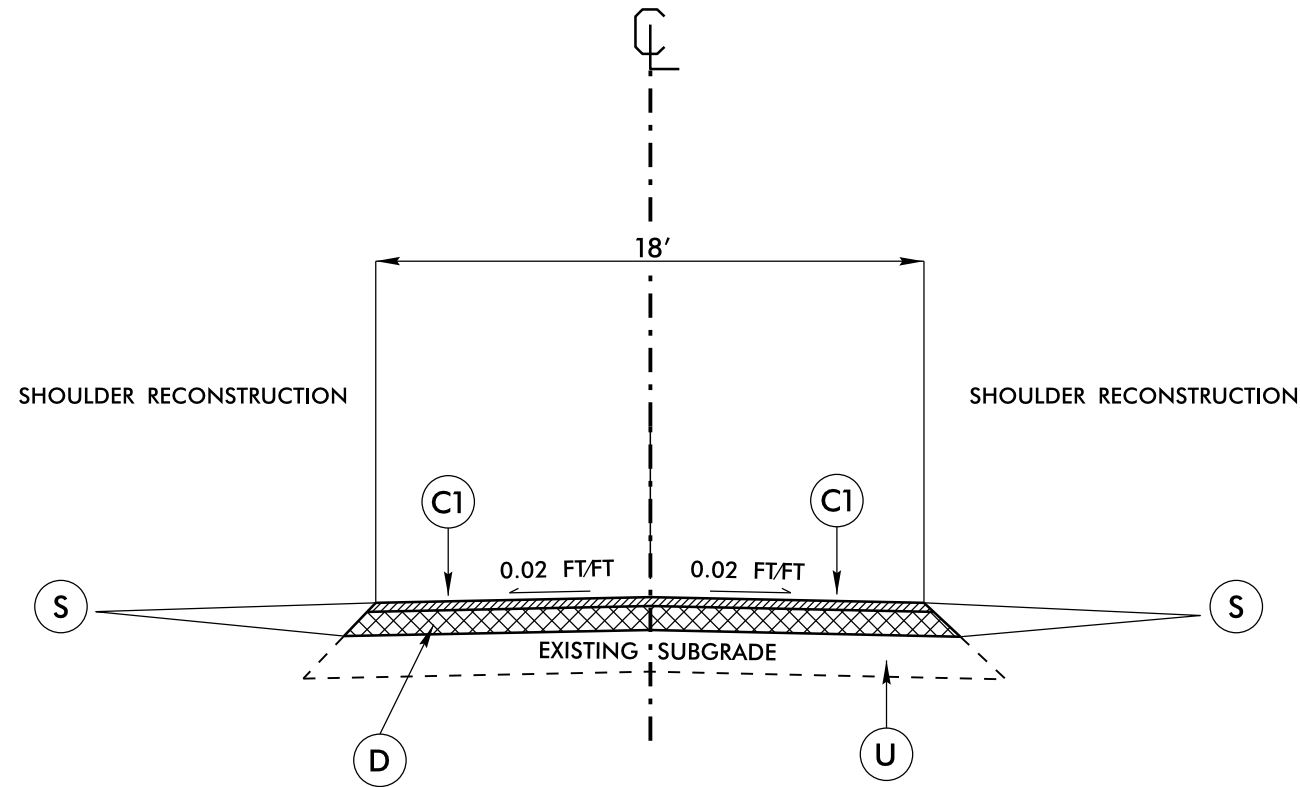

RANDOLPH COUNTY

SR 1372 RIDGE MTN. TRL. EXT.

PAVEMENT SCHEDULE	
C1	PROP. APPROX. 1.5" ASPHALT CONCRETE SURFACE COURSE, TYPE SF 9.5A, AT AN AVERAGE RATE OF 165 LBS. PER SQ. YD.
D	PROP. 2.5" APSHALT CONCRETE INTERMEDIATE COURSE, TYPE 119.0B AT AN AVERAGE RATE OF 285 LBS. PER SQ. YD.
U	EXISTING SUBGRADE
S	AGGREGATE SHOULDER BORROW

TYPICAL SECTION NO. 2

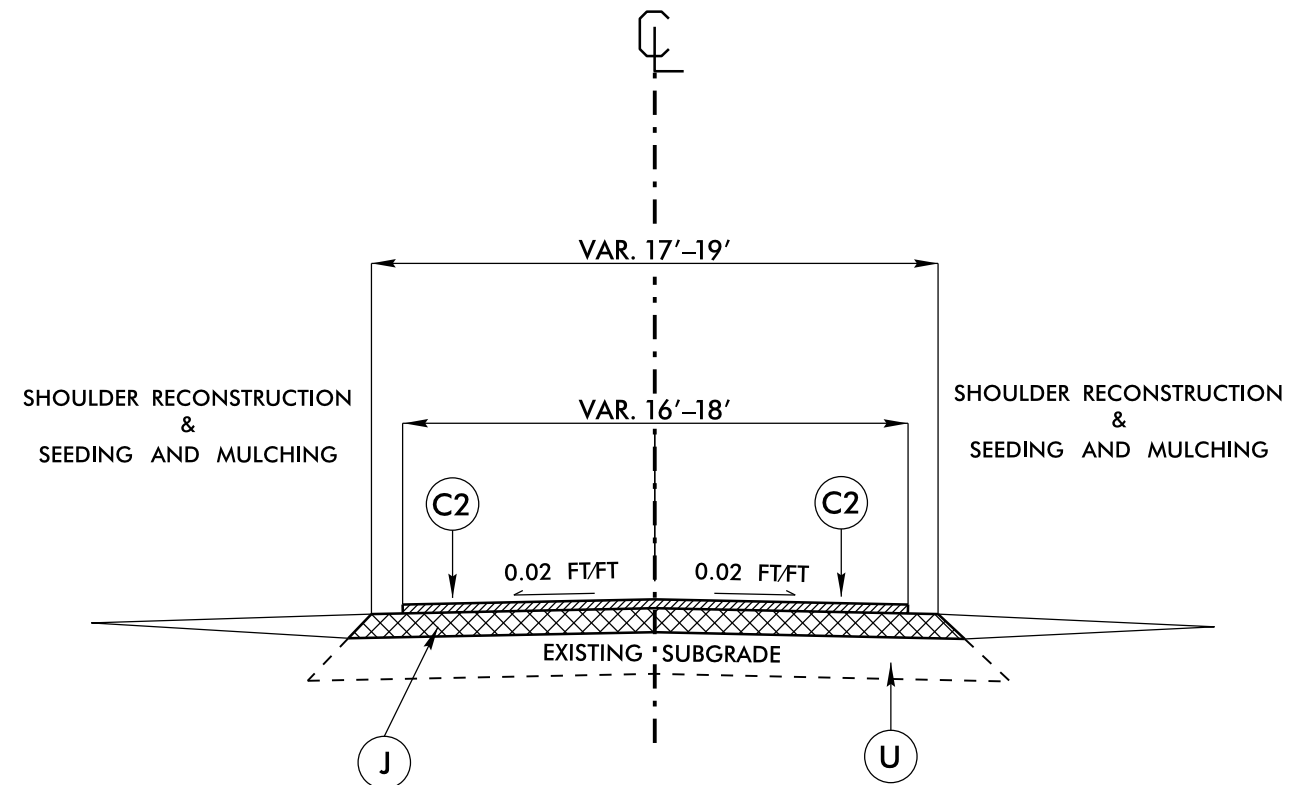

RANDOLPH COUNTY

SR 2104 HOCKETT COUNTRY LN.

PAVEMENT SCHEDULE	
C2	PROP. APPROX. 2" ASPHALT CONCRETE SURFACE COURSE, TYPE SF 9.5A, PLACED IN TWO EQUAL LIFTS AT AN AVERAGE RATE OF 110 LBS. PER SQ. YD. EACH
J	PROP. 10" COMPACTED AGGREGATE BASE COURSE.
U	EXISTING SUBGRADE

PROJECT NO.	SHEET NO.	TOTAL NO.
8C.076138, 8C.076152	4	

SUMMARY OF QUANTITIES

PROJECT NO	COUNTY	MAP NO	ROUTE	DESCRIPTION	TYP	LANES	FINAL SURFACE TESTING REQUIRED	WARM MIX ASPHALT REQUIRED	LENGTH MI	WIDTH FT	AGGREGATE SHOULDER BORROW TON	FINE GRADING LS	AGGREGATE BASE COURSE TON	INCIDENTAL STONE BASE TON	SHOULDER RECONSTRUCTION SMI	PRIME COAT GAL	INTERMEDIATE COURSE, I19.0B TONS	SURFACE COURSE, SF9.5A TON	ASPHALT BINDER FOR PLANT MIX TON	BLOTTING SAND TON
8C.076138	Randolph	1	SR 1372 (RIDGES MTN TRAIL EXT.)	FROM END PAVEMENT TO DEAD END	1	2	NO	NO	0.26	18	52	0.34			0.52	15	396	251	36	100
TOTAL FOR MAP NO. 1									0.26		52	0.34			0.52	15	396	251	36	100
TOTAL FOR PROJ NO. 8C.076138									0.26		52	0.34			0.52	15	396	251	36	100
8C.076152	Randolph	2	SR 2104 (HOCKETT CTRY LN)	FROM SR 2103 TO GUILFORD COUNTY LINE	2	2	NO	NO	0.5	20		0.66	4,000	25	1.00	2,000		633	42	20
TOTAL FOR MAP NO. 2									0.5			0.66	4,000	25	1.00	2,000		633	42	20
TOTAL FOR PROJ NO. 8C.076152									0.5			0.66	4,000	25	1.00	2,000		633	42	20
GRAND TOTAL									0.76		52	1	4,000	25	1.52	2,015	396	884	78	120

PROJECT NO	COUNTY	MAP NO	ROUTE	DESCRIPTION	TYP	LANES	FINAL SURFACE TESTING REQUIRED	WARM MIX ASPHALT REQUIRED	LENGTH MI	WIDTH FT	SEED & MULCHING AC	SEED FOR REPAIR SEEDING LB	FERTILIZER FOR REPAIR SEEDING TON	TEMPORARY TRAFFIC CONTROL LS
8C.076138	Randolph	1	SR 1372 (RIDGES MTN TRAIL EXT.)	FROM END PAVEMENT TO DEAD END	1	2	NO	NO	0.26	18				0.34
TOTAL FOR MAP NO. 1									0.26					0.34
TOTAL FOR PROJ NO. 8C.076138									0.26					0.34
8C.076152	Randolph	2	SR 2104 (HOCKETT CTRY LN)	FROM SR 2103 TO GUILFORD COUNTY LINE	2	2	NO	NO	0.5	20	0.50	20	0.20	0.66
TOTAL FOR MAP NO. 2									0.5		0.50	20	0.20	0.66
TOTAL FOR PROJ NO. 8C.076152									0.5		0.50	20	0.20	0.66
GRAND TOTAL									0.76		0.50	20	0.20	1

4457000000-N